



162 Ashby Road

, Burton-On-Trent, DE15 0LG

Offers in the region of £360,000

 3
  2
  2
  D

Burton's only "Legally Trained" Estate Agent brings to this market this exceptionally well presented 3 bedroom detached family home.

This stunning property is situated along one of the main arterial roads leading to the centre of Burton-on-Trent. Located within an area of contrasting homes, the property is well served by a wealth of amenities and lies within easy access of good commuter routes and a number of local major centres of employment.

This family home has the benefit of uPVC double glazing and gas central heating, and recently the Vendors have fitted a brand new boiler.

The accommodation is well presented throughout and is set over two floors. On the ground floor, we have a spacious reception room, a large dining room, a shower room, a generously sized fitted kitchen, and a conservatory located at the rear end of the home. The first floor comprises three generously sized bedrooms and a large family bathroom.



- RECEPTION 13'5" x 11'9" (4.1 x 3.6)
- DINNING ROOM 14'5" x 11'9" (4.4 x 3.6)
- DOWNSTAIRS SHOWER ROOM 6'10" x 3'7" (2.1 x 1.1)
- KITCHEN 11'1" x 9'6" (3.4 x 2.9)
- UTILITY ROOM 6'6" x 4'3" (2 x 1.3)
- CONSERVATORY 20'0" x 7'6" (6.1 x 2.3)
- MASTER BEDROOM 12'1" x 11'9" (3.7 x 3.6)
- BEDROOM TWO 12'5" x 8'6" (3.8 x 2.6)
- BEDROOM THREE 14'1" x 9'6" (4.3 x 2.9)
- FAMILY BATHROOM 8'2" x 7'2" (2.5 x 2.2)

Area Map



Floor Plans

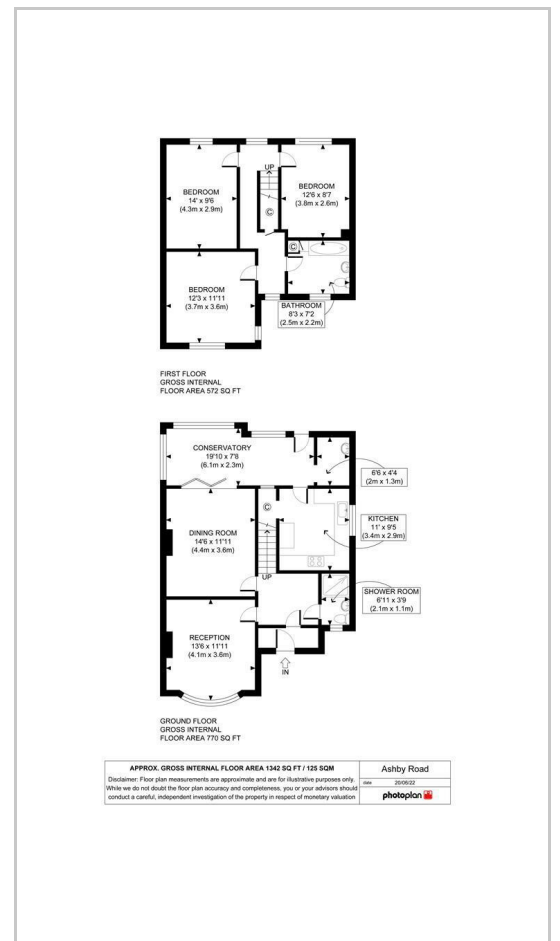

Energy Efficiency Graph

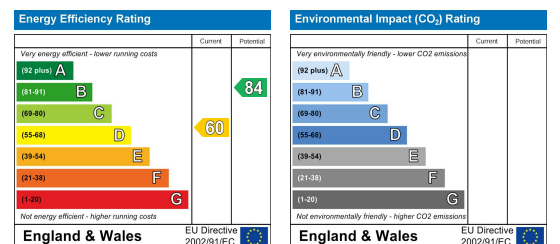

These particulars, whilst believed to be accurate are set out as a general outline only for guidance and do not constitute any part of an offer or contract. Intending purchasers should not rely on them as statements of representation of fact, but must satisfy themselves by inspection or otherwise as to their accuracy. No person in this firm's employment has the authority to make or give any representation or warranty in respect of the property.